

Operating instructions

for wine cooler

GB

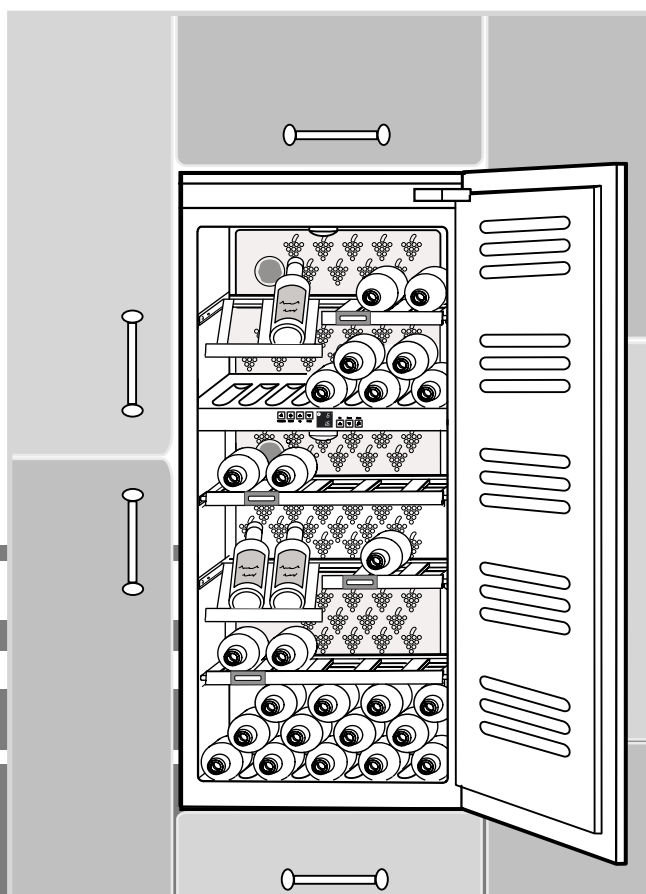

7082 420-00

WTI.. 11/06

LIEBHERR

Congratulations on the purchase of your new appliance. With this purchase you have chosen all the advantages of the latest refrigeration technology, guaranteeing you a high quality appliance with a long life span and high operating safety.

The equipment of your appliance gives you the highest level of ease of operation on a day-to-day basis. With this appliance, manufactured in an environmentally-friendly process using recyclable materials, you and we are together making an active contribution to the conservation of our environment.

To get to know about all the advantages of your new appliance, please read the information in these instructions carefully.

We hope you enjoy your new appliance.

Please keep the operating instructions in a safe place and pass them on to any new owner, if necessary.

Contents

Operating instructions	Page
Contents	12
Definitions	12
Information on energy saving.....	12
Information for Test Institutes	12
Appliance at a glance	13
Disposal advice	14
Safety and warning information	14
Technical safety	14
Safety when using	14
Installation instructions	14
Connecting to the electrical supply	14
Installation	15
Appliance dimensions	15
Changing over door hinges	15
Information on building in.....	16
Fastening and mounting	17
Operating elements and controls	18
Wine storage	18
Switching on and off	18
Setting the temperature	18
Temperature display	18
Alarm - Acoustic warning.....	18
Ventilator switch.....	18
Additional functions	19
Child safety device	19
Brightness	19
Equipment	19
Interior lighting	19
Labels.....	19
Wooden shelves	19
Cleaning	20
General	20
Active carbon filter.....	20
Condensation water drainage channel	20
Faults - Problems	21
Customer service.....	21
Disposal.....	21

Definitions

- The appliance is intended for cooling wine. It is designed for domestic use. If put to another use, problem-free operation cannot be guaranteed.
- Depending on the climatic class, the appliance is designed for operation at the ambient temperature limits indicated. They should not be exceeded at either end of the range! The climatic class relating to your appliance is printed on the rating plate. It means:

Climatic class	designed for Ambient temperatures of
SN	+10 °C to +32 °C
N	+16 °C to +32 °C
ST	+18 °C to +38 °C
T	+18 °C to +43 °C

- The refrigerant cycle is tested for tightness.
- The appliance conforms to the relevant safety regulations and the EC Directives 73/23/EC and 89/336/EC.

Information on energy saving

- Make sure that the ventilation sections are kept free.
- Only open the door of the appliance for as brief a time as possible.
- Arrange the food in a logical order. Do not exceed the maximum storage times given.
- In the event of a power cut, keep the door of the appliance closed. This delays the loss of cold. The quality of the frozen food is retained for longer.

Information for Test Institutes:

As there are currently no energy efficiency guidelines for wine coolers, the two wine compartments are rated as cellar compartments in the energy efficiency classification.

Appliance at a glance

GB

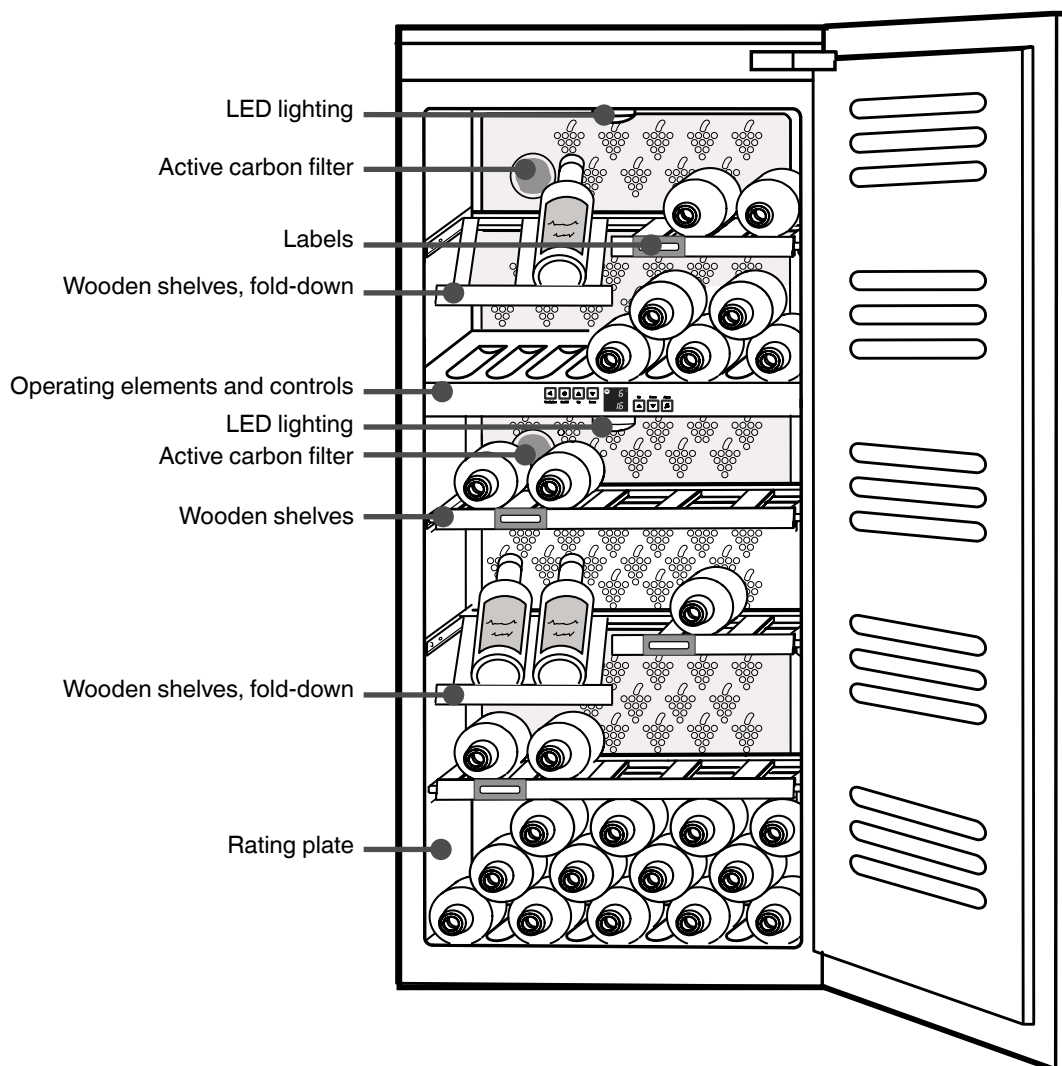

Safety and warning information

Disposal advice

The **packaging** for protection of the appliance and individual parts during transportation is made from recyclable materials.



- Corrugated cardboard/cardboard
- Preformed pieces made of PS (foamed, CFC-free polystyrene)
- Films and bags made of PE (polyethylene)
- Packing bands made of PP (polypropylene)
- **Packaging materials are not children's toys - risk of suffocation from plastic film!**

Technical safety

- To avoid personal injury and material damage, only transport the appliance when packed in the packaging materials and install with two people present.
- The refrigerant contained within the appliance, R 600a, is environmentally friendly, but flammable.
- Do not damage the pipes of the refrigerant circuit. Spurting refrigerant may lead to eye injuries or may ignite.
- If refrigerant escapes, remove naked flames or sources of ignition from near where it is escaping, pull out the mains plug and ventilate the room well.
- In the event of damage to the appliance, check with the supplier immediately - before connecting to the mains supply.
- To ensure safe operation of the appliance, only install and connect the appliance in accordance with the operating instructions.
- In the event of fault, disconnect the appliance from the mains supply: remove the mains plug (do not pull on the mains cable to do this) or remove or turn off the fuse.
- **Only have repairs and interventions on the appliance carried out by the Customer Care Service, otherwise serious risks to the user may arise.** The same applies to changing the mains cable.



Safety when using

- Do not store any explosive materials or aerosols with flammable propellants, such as butane, propane, pentane, etc. in the appliance. Any leaking gases could be ignited by electrical components. You can recognise such aerosols by the printed contents or by a flame symbol.
- High-proof alcohol should only be stored tightly sealed and upright.
- Do not handle naked flames or ignition sources inside the appliance.
- Do not use any electrical devices inside the appliance (e.g., steam cleaners, heaters, etc.)
- Plinth, drawers, doors, etc. are not intended to be stood on, so do not mistreat them in this way.
- This appliance is not designed for use by persons (or children) with physical, sensory or mental impairment or persons, who do not have sufficient experience and knowledge, unless they have been instructed or initially supervised by a person, who is responsible for their safety, in the use of the appliance. Children should not be left unsupervised to make sure that they do not play with the appliance.
- Avoid long skin contact with cold surfaces or cooled products. This can lead to pain, feelings of numbness and frostbite. In the event of skin contact lasting a while, take protective steps, e.g. use gloves.
- Do not consume food that has been stored for too long, it can cause food poisoning.



Installation instructions

- When installing/building in, make sure that the pipes of the refrigerant circuit are not damaged.
- The installation space for your appliance must have a volume of 1 m³ per 8 g of refrigerant R 600a in accordance with the standard EN 378, so that in the event of a leak in the refrigerant circuit no flammable gas-air mixture can occur in the appliance's installation space. The details of the amount of refrigerant contained is to be found on the rating plate inside the appliance.
- Avoid sites in the area of direct sunlight, near cookers, heaters and the like, and in damp areas or where water can be splashed.
- **The ventilation grilles must not be blocked. Always ensure good ventilation!** For more information on this subject, please see the installation and conversion instructions.
- Do not place any appliances that give off heat, e.g. microwave, toaster, etc. on the appliance.
- Remove all transport safety devices,
 - remove sticky tape or spacers from the shelves.
 - Remove all protective films: on the front and side walls*.

Connecting to the electrical supply

Type of current (alternating current) and voltage

at the installation site must match the details on the rating plate. This is located on the left-hand side inside the appliance,



- **Only connect the appliance via a correctly installed shockproof socket.**
- The power point must be protected with a fuse of 10 A or higher, be outside the area of the back of the appliance and be easily accessible.
- Do not
 - connect the appliance to island power inverters (e.g. battery),
 - operate the appliance in combination with so-called energy-saving plugs - the electronics can be damaged,
 - connect the appliance with other appliances via an extension cable - danger of overheating.
- When taking the mains cable from the back of the appliance remove the **cable holder** - otherwise vibration noises!

The wires in the mains lead are coloured in accordance with the following code: green/yellow = earth, blue = neutral, brown = live.

Warning! This appliance must be earthed.

Non-rewireable plugs BS 1363

If this machine or appliance is fitted with a non-rewireable plug, the following information applies: If the socket outlets are not suitable for the plug supplied with this product, it must be cut off and an appropriate plug fitted. The plug cut from the flexible cord should be disposed of and on no account be inserted into a 13 A socket elsewhere in the house (electric shock hazard).

The fuse cover **must** be re-fitted when changing the fuse, and if the fuse cover is lost the plug **must not** be used until a suitable replacement is obtained. The colour of the correct replacement cover is that of the coloured insert in the base of the plug, or the colour that is embossed in words on the base of the plug (as applicable to the design of the plug fitted). The correct rating of the replacement fuses that are ASTA approved to BS 1362 should be fitted. Replacement fuse covers may be purchased from your local electrical suppliers, electricity showroom or approved service agent.

Installation

Appliance dimensions

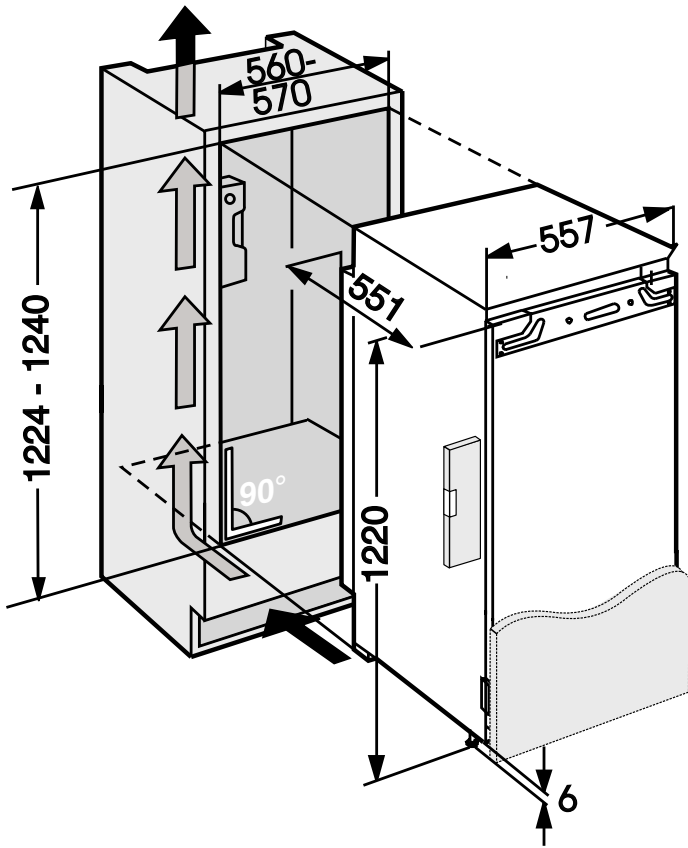

Reversing the door

GB

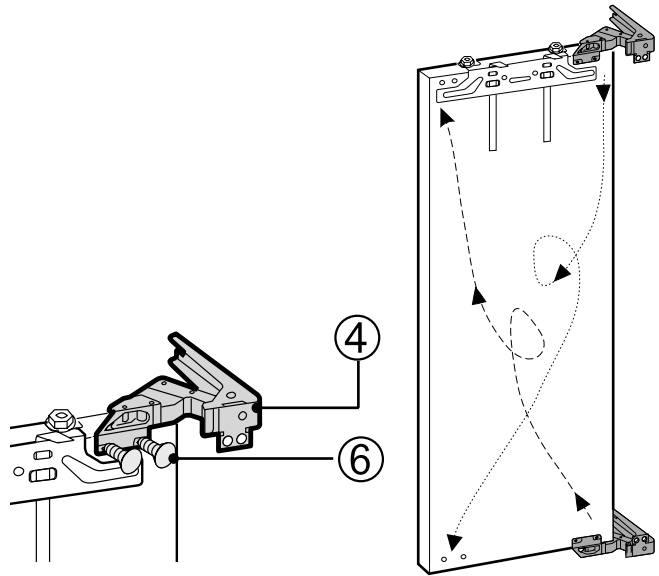

- Unscrew fastening screws ③ in the hinges ④ at the top and bottom and move to the other side. Screw in a little way.
- Undo the screws in the door fastening ⑥ at the top and the bottom. Move the hinge from the top right to the bottom left. Move the bottom right hinge to the top left.
- **Important, do not shut up the hinges - risk of injury!**
- Hang appliance door on the pre-mounted screws ③ and tighten screws.

Changing over door hinges

To change the side on which the door is hung you will need the following tools: Phillips screwdriver, Torx screwdriver

For easier mounting, push the appliance 3/4 of the way into the recess. Open door.

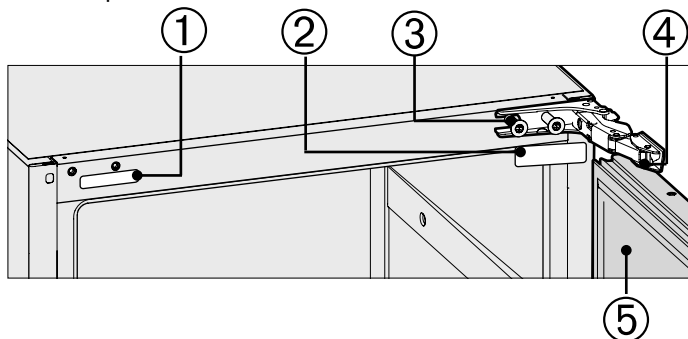

- Lift off covers ① and ② at the top and the bottom with the help of a slotted screwdriver.
- Just loosen fastening screws ③ in the top and bottom hinges ④.
- The door ⑤ together with the hinge can now be pushed outwards and taken off. Put door to one side.

How to build in

- The appliance can be used as a substitute fixture. In this case take off the mountings from the kitchen cabinet door and the recess. They are no longer required as the cabinet door is fitted onto the appliance door.
- Only build the fridge into units that are firmly fixed.
- Make cupboard level using spirit level and set square. If necessary, even out by placing something underneath. Floor and side wall of the cupboard must be perpendicular to one another.
- The ventilation sections must be maintained:
 - The depth of the ventilation shaft at the back wall of the cupboard must be at least **38 mm**.
 - For the ventilation sections in the plinth of the cupboard and at the top of the cupboard at least **200 cm²** is required. Basically: the bigger the ventilation section, the more energy saving the operation of the appliance.
- **Check the installation dimensions of appliance and recess**

Installation

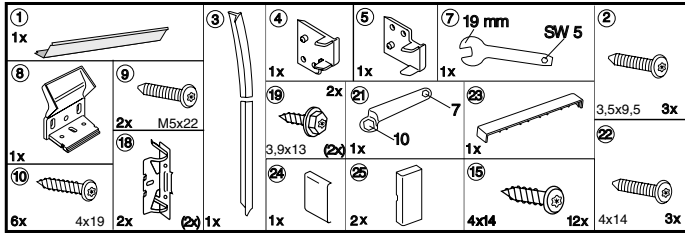

All fastening elements are supplied with the appliance.

- Attach aligning panel ① with screws ② to the appliance.

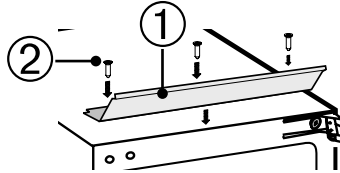

- Position the mains cable using a piece of string so that the appliance can easily be connected to the electricity supply after it has been built-in.
- Push the appliance 3/4 of the way into the recess.

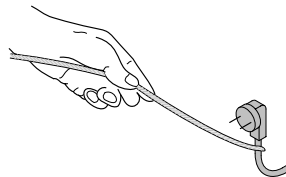

- **Take into account thickness of the fixture walls:**
With 16 mm thick cupboard walls = 568 mm wide recess:

- Stick cover strip ③ onto the side wall of the appliance on the handle side and flush with the front: Remove protective film and stick strip on;

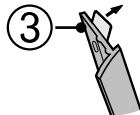

- Clip spacer ④ onto the top hinge and spacer ⑤ onto the bottom hinge.

- Push appliance into the recess until the spacers touch the side wall of the cupboard

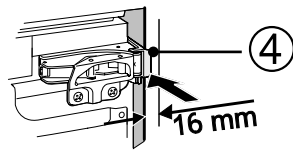

- **With 19 mm thick cupboard walls = 562 mm wide recess:**

- Push appliance into the recess until the front edges of the hinges are flush with the side wall of the cupboard. With cupboards with door stop parts (knobs, sealing lips, etc.) take into consideration the space for setting up! Have hinges ⑥ project by the extent needed for setting up. Push appliance up against the cupboard wall on the hinge side.

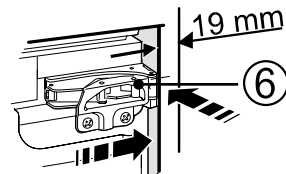

- Adjust the appliance so that it stands level using the open-ended spanner ⑦ supplied on the adjustable feet. Align the side walls of the appliance parallel to the front edges of the side walls of the cupboard.

- Screw on plastic angle ⑧ using M5 screws ⑨ on the handle side of the appliance.

- Align the plastic angle ⑧ flush with the front edge of the floor of the cupboard. With door stop parts (knobs, sealing lips, etc.) take into consideration the space for setting up and align parallel to the front edge of the hinge.

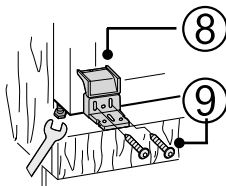

- Using long chipboard screws ⑩ screw through the hinged brackets at the top and bottom.

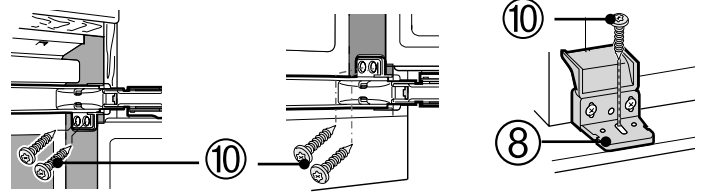

- Preassemble with long chipboard screws ⑩ through the middle of the slot in the plastic angle ⑧. Snap on plastic angle's cover and close the door of the appliance.

Assembling cupboard door

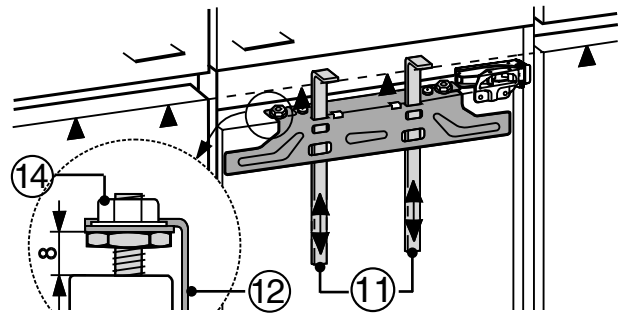

- Check default measurement of 8 mm (distance between door of appliance and bottom edge of cross beam).

- Push up mounting devices ⑪ to height of cupboard door. Lower stop edge ▲ of the mounting device = upper edge of the cupboard door to be mounted.

- Hang fastening crossbeam ⑫ on the cupboard door ⑬ :

- To do this, unscrew check nuts ⑭.

- Hang the cross-beam ⑫ using the mounting devices ⑪ on the inside of the cupboard door and align centrally (mark short centre line on cupboard door, place arrow head of the crossbeam on top, distances to the outer edge must be equal to the left and right).

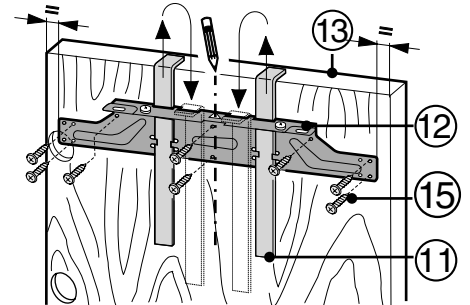

- Screw on fastening crossbeam ⑫ in the middle :

- In the case of chipboard doors with at least 6 screws ⑮,
- in the case of frame and panel doors with 4 screws ⑮ at the edge.

- Pull out mounting devices ⑪ upwards and push turned into the neighbouring openings.

- Hang cupboard door ⑬ on the appliance door ⑩/adjustable bolts ⑪, screw check nuts ⑭ loosely onto the adjustable bolts.

Fastening and mounting

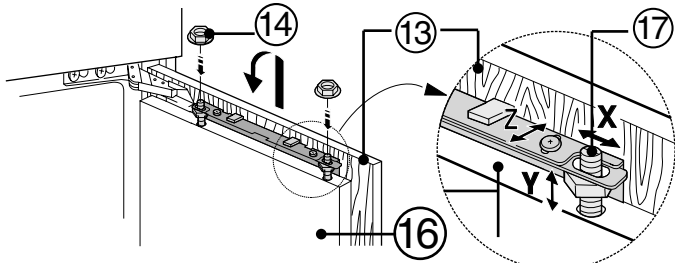

Close door.

- Align the cupboard door flush with the surrounding cupboard fronts : Adjust lateral alignment **X** by moving sideways, height alignment **Y** and lateral incline by adjusting the adjustable bolts (17) - with a screwdriver.
- Check the gap between the door and the surrounding cupboard doors.
- Tighten check nuts (14).
- Screw fastening angle (18) using hexagon bolts (19) to the pre-bored holes in the appliance door.

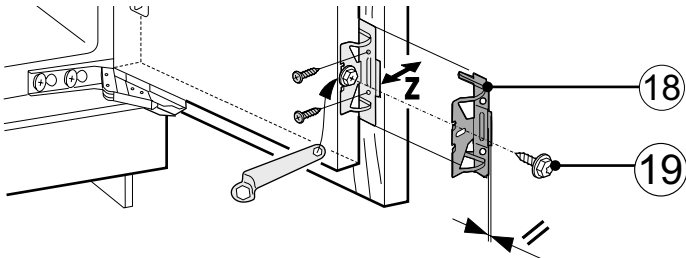

- Screw down appliance door (14) through the fastening angle (18) to the cupboard door:
- Ensure fastening angle and appliance door are flush, symbol //.
- Then bore fastening holes in the cupboard door (if necessary, pierce with a gimlet) and fasten with screws.
- Align cupboard door (13) front to back **Z**:
- At the top: loosen the Torx screws (20) ,

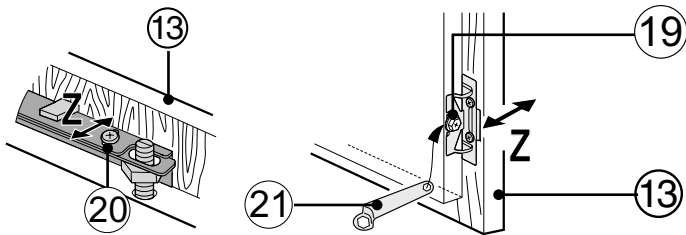

- At the bottom: loosen the hexagon bolts (19) with the ring spanner supplied (21) and move the door.
- Between cupboard door and body of cupboard make an air gap of about 2 mm. Do not allow knobs and sealing lips to be touched - **important for operation!**

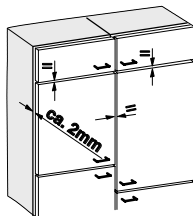

- In the case of large or split cupboard doors mount a 2nd pair of fastening angles (18) (accessories bag). To do this, use the pre-bored holes in the area of the handle on the appliance door.
- Check the fit of the door, if necessary, re-adjust. Tighten all screws.

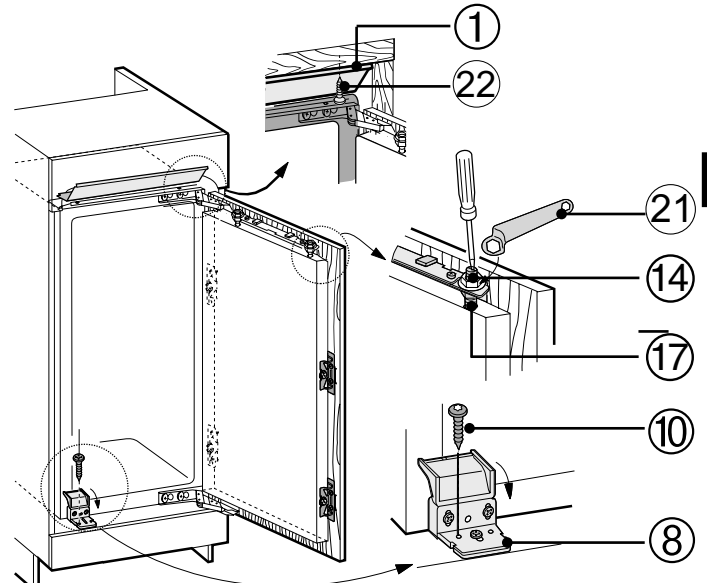
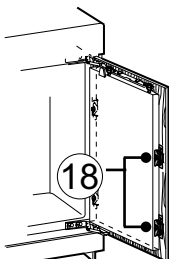

GB

- Tighten the check nuts (14) using the ring spanner (21) , while holding the adjustable bolts (17) with a screwdriver.
- Screw the aligning panel (1) from below using three screws (22) onto the cupboard ceiling .
- Fasten appliance at the bottom through plastic angle (8) with second screw (10) in the round hole.

- Position upper cover (23) and click into place. Push on side covers (24) and (25) and clip on. The two side covers must audibly engage.

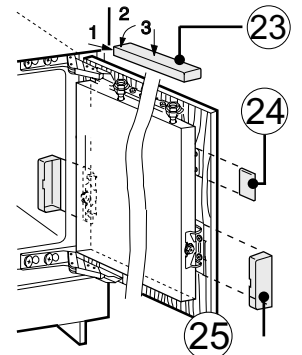

- The door's end stop spring can be adjusted. As required, adjust using Allen key 5 supplied:
- turn clockwise = stronger spring resistance
- turn anti-clockwise = weak spring resistance (ex-factory setting).

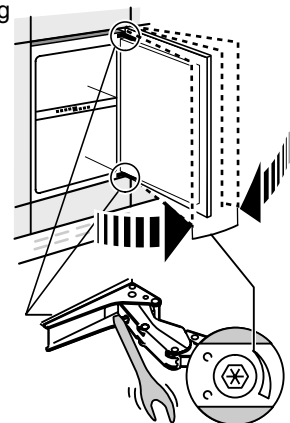

The manufacturer is constantly working on the development of all models. Please understand therefore that we must reserve the right to make changes to form, equipment and technology.

Operating elements and controls

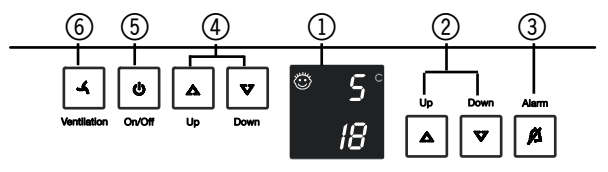

- ① Temperature display and settings display
- ② Setting buttons for temperature, lower wine cooler zone
- ③ Alarm button
- ④ Setting buttons for temperature, upper wine cooler zone
- ⑤ On/Off button
- ⑥ Ventilator button

Wine storage

23 Bordeaux bottles can be stored in the upper compartment and in the lower compartment up to 41 Bordeaux bottles .

Switching on and off

- **To switch on:** Press On/Off , so that the temperature displays light up/flash.
- **To switch off:** Press On/Off for about a second, so that the temperature displays go out.



Setting the temperature

The wine cooler zone can be set between 5 and 18 °C .

- The wine cooler zone is divided into two areas, which can be set to different temperatures, if required.

The “Up” and “Down” buttons on the left of the display control the upper compartment .



The “Up” and “Down” buttons on the right of the display control the lower compartment.

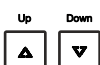

- **To lower the temperature/colder:** Press the **Down** button.
- **To raise the temperature/warmer:** Press the **Up** button.

- During setting, the **setting value set flashes** in the display.
- When the temperature setting buttons are pressed for the first time, the last value set appears in the display(= desired value).
- Repeated short presses on the buttons changes the value set in 1 °C steps. longer presses change the value continuously.
- About 5 seconds after the last press of the buttons, the electronics automatically change over and the actual fridge temperature (= actual value) is displayed.
- The altered temperature gradually adjusts itself slowly to the new value.

Temperature display

In normal operation:

- the average wine cooler temperature is displayed



The display flashes, when

- you alter the temperature setting,
- the wine cooler temperature is too cold or
- the temperature has risen by several degrees, as an indication of a loss of cold, e.g. when re-arranging the bottles. After you have finished storing or re-arranging bottles, the electronics automatically adjust the temperature to the last setting.
- If a “F 0” to “F 5” should appear in the display, there is a fault with the appliance. Then please contact your Customer Care Service and inform them of this message. This facilitates fast, targeted service.

Alarm - Acoustic warning

The acoustic warning helps you to protect your stored wine and to save energy.

- **The acoustic tone stops** when the Alarm Off button is pressed
- automatically, when a cold enough storage temperature is reached again or
- the door is closed.



Door alarm

- It always sounds, when the door is open for longer than about 60 seconds.

The tone remains switched off until the door is opened. When the door is closed, the alarm function is automatically readied again.

Temperature alarm

It always sounds, when the

- wine storage temperature is too warm or too cold

The temperature display continues to flash until the alarm condition has ended. Then it switches from flashing to being permanently lit. At the same time the acoustic warning is again automatically readied for operation.

Ventilator switch

The ventilator switch increases the relative air humidity in the wine cooler zone. This achieves an environment in the interior which corresponds to that of a wine cellar. The increased air humidity prevents the corks drying out.

- **To switch on:**
- Briefly press “Ventilation” button so that it lights up.



- **To switch off:** briefly press again, so that the ventilator symbol in the display goes out.
- The ventilator then runs only in parallel with the compressor = lower air humidity.

Note:

- When the ventilator is switched on, energy consumption is increased.
- To save energy, the ventilator switches off automatically when the door is open.

Operating elements and controls

Additional functions

Via the setting mode you can use the child safety device and change the brightness of the display. With the child safety device you can protect the appliance against being switched off unintentionally.

To activate setting mode:

- Press ventilator button for about 5 seconds - the ventilator button flashes - the display shows **c** for child safety device.



Note: The respective value to be changed flashes.

- By pressing the Up/Down button, select the desired function: **c** = child safety device, **h** = brightness
- Now by pressing the ventilator button briefly, select/confirm the function:

When **c** = child safety device

by pressing the Up/Down button, select

c1 = child safety device on or

c0 = child safety device off and confirm with the ventilator button. When the symbol is lit, the child safety device is active.



When **h** = brightness

by pressing the Up/Down button, select

h1 = minimum to

h5 = maximum brightness and confirm with the ventilator button.



To leave setting mode:

- Press the On/Off button to end setting mode; after 2 mins. the electronics automatically switch over. Normal operation is active again.



Equipment

Interior light

An LED light is integrated in the upper and lower compartment.

The light may only be changed by the Customer Care Department or by technicians trained to do so.

GB

CAUTION

Laser radiation class 1M.

When cover is open, do not look at directly with optical instruments.

Labels

The appliance is fitted with one label holder per wooden shelf. Use these labels to identify the wine type stored on the wooden shelf. Use a soft pencil to write on the labels. The writing can then be easily corrected or erased, if necessary.

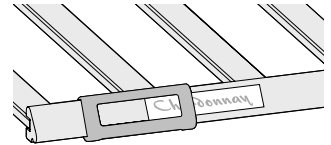

Additional labels can be bought from your dealer .

Fastening: Clip the label holder on the wooden shelf at the desired place. The label is then pushed in under the label holder from the side.

Folding down the wooden shelf

In each wine cooler compartment your appliance has a wooden shelf that can be folded down. Use this option to safely store bottles of wine that have already been opened.

To fold down the wooden shelf, press the catch that is located under the panel to the side. The wooden shelf folds down.

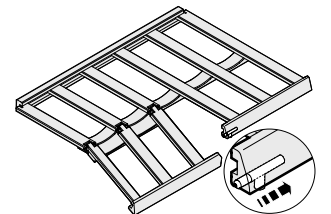

Taking out the wooden shelves

The fold-down wooden shelf runs on pull-out rails. To take out the wooden shelf, lift the shelf upwards off the pull-out rail and then pull it out forwards. Make sure that the wooden shelf does not remain caught on the hook at the back. To put back, push the shelf under the hook at the back and then press the wooden shelf onto the rails, so that they audibly engage.

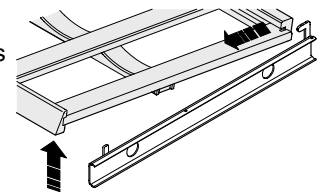

All other wooden shelves are only set on the rails and do not have to be hooked on.

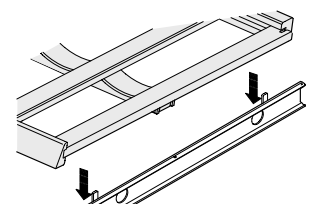

Cleaning

- **Before cleaning, always switch the appliance off. Remove the mains plug from the power point or unscrew or take out the fuses.** 
- Clean external walls, interior and fittings, with the exception of the wooden shelves, by hand with lukewarm water and a little washing up liquid. Do not use steam cleaners - risk of injury and damage!
- Soft cleaning cloths and an all-purpose cleaner with a neutral pH-value is recommended. Only use cleaners and maintenance products that are not harmful to food in the interior of the appliance.
- Make sure that no cleaning water gets into the drainage channel, ventilation grills and electrical parts. Dry the appliance with a cloth.
- Do not damage the rating plate inside the appliance or remove it - it is important for the Customer Care Department.
- **The refrigerating unit with the heat exchanger - metal grille on the back of the appliance - should be cleaned and dust removed once a year.** Dust deposits increase energy consumption.
- Make sure that no cables or other components are torn, kinked or damaged.
- After this, connect/switch on the appliance again and load the cooled goods as the temperature starts to fall.



Cleaning condensation water drainage channel

Condensed water evaporates due to the heat of the condensor - water droplets on the back wall are caused by operation and are completely normal.

- Make sure that the condensed water can flow unhindered through the drainage hole in the back wall
- To clean the **condensed water drainage channel** on the back wall, do the following: Take out the wooden shelves and remove the pull-out rails. Remove the caps and screws from the metal cover and place to one side ①. Lift the metal cover ② and pull forwards ③. Clean the drainage channel, if required, with a cotton bud or similar

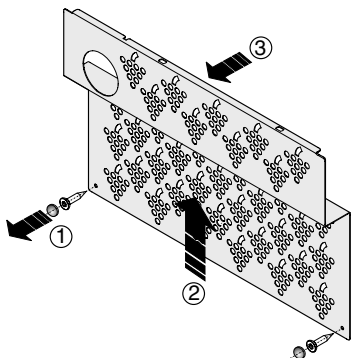

- Wipe the rubber lip of the control panel with a damp cloth and a pH-neutral cleaning agent.

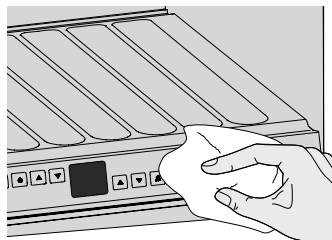

If the appliance is **not to be used for a while**, then empty the appliance, remove the mains plug from the power point, clean as described and leave the appliance door open, to avoid the build up of unpleasant smells.

Changing the active carbon filter

Wines continue to develop all the time depending on the environmental conditions; therefore the quality of the air is of prime importance for conservation. In each wine cooler compartment an active carbon filter is installed to ensure an optimum air throughput. To see the position, please see the appliance overview.

We recommend the annual replacement of the filter portrayed here, which you can order from your dealer.

Changing the filter:

- Take hold of the filter by the handle. Turn it 90° to the right or the left. Then the filter can be pulled out.
- Insert filter: Insert the filter with the handle in a vertical position. Turn it 90° to the right or the left, until it engages into place.

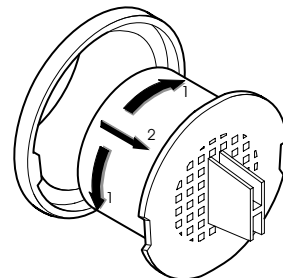

Faults - Problems?

Your appliance is constructed and manufactured to give functional safety and a long life.

Should however a fault occur during operation, then please check whether the fault can possibly be due to an operator's error, because in this case you must pay for the costs arising, even during the warranty period.

You can remedy the following faults yourself by checking the possible causes:

Fault	possible cause and remedy
-------	---------------------------

Appliance is not working, display is dark

- Is the appliance switched on properly?
- Is the mains plug in the power point properly?
- Is the fuse in the plug OK?

Noises are too loud

- Is the appliance standing firmly on the floor, are units or objects standing next to it made to vibrate by the running of the refrigerating unit? Perhaps move the appliance away a little, even up using the adjustable feet, move bottles and containers away from one another.
- The following are normal: flowing sounds, a bubbling or splashing, these come from the refrigerant that flows in the refrigerant circuit.
A slight clicking sound, this always happens when the refrigerating unit (the motor) automatically switches on or off.
A humming motor. It is a little louder briefly, when the unit switches itself on. After the door has been open a long time, the refrigerating capacity automatically increases.

Alarm sounds, temperature is not cold enough

- Is the appliance door closed properly?
- Is the ventilation sufficient?
Perhaps free up the ventilation grilles.
- Is the ambient temperature too warm?
(see section "Definitions")
- Has the appliance been open too often or for too long?
- Perhaps wait and see if the required temperature is re-set by itself.
- Please be aware that, as with other forms of storage, depending on the type of label adhesive, a slight mould can form. The remedy in this case is to carefully clean adhesive residues from the bottles.

Appliance sometimes feels warm on the outside surfaces

- This is completely normal. The heat of the refrigerant circuit is used to prevent condensation.

Customer Care Department and rating plate

When there are none of the above causes and you have not been able to remedy the problem yourself or when a "F 0" to "F 5" appears in the temperature display, this means: there is a fault. In this case, contact your nearest Customer Service Centre (directory enclosed). Inform them of this **message**, also the



- name of the appliance** ① ,
- service number** ② ,
- appliance number** ③

from the rating plate. This facilitates fast, targeted service. The rating plate is located on the left-hand side inside the appliance. Leave the appliance closed until the Customer Care Department engineer arrives, to prevent a further loss of cold.

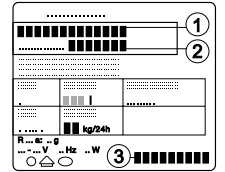

GB

Disposal

When the appliance is finished with:

It still contains valuable materials and is to be taken to a collection point separate to the unsorted municipal waste.



- Make old appliances unusable immediately, remove the mains plug from the power point and cut through the mains cable.
Remove the spring lock or bolt, so that children playing cannot shut themselves in - they will suffocate.
- Make sure that there is no damage to the refrigerant circuit before the old appliance is collected or taken to the collection points set up by the local authority. This is to ensure that the refrigerant and oil contained in it does not leak out in an uncontrolled manner.
- You will find exact details of the refrigerant used on the rating plate. Heat insulator is PU with pentane.
- You can get information about home collection services or collection points from your local waste management services or local authority.